

Description

| MOSFET Product Summary | | |
|------------------------|-----------------------|----------|
| $V_{DS}(V)$ | $R_{DS(on)}(m\Omega)$ | $I_D(A)$ |
| 1700 | 45 | 72 |

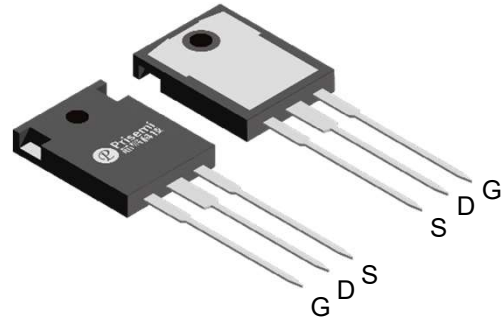

TO-247-3L (Top View)

Feature

- High Speed Switching with Low Capacitances
- High Blocking Voltage with Low RDS(on)
- Avalanche Ruggednes

Applications

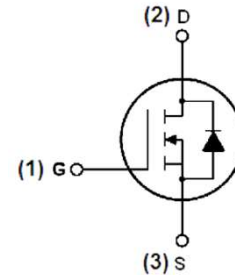
- Solar Inverters
- Switch Mode Power Supplies
- High Voltage DC-DC Converters
- Battery Chargers

Schematic diagram

Absolute maximum rating@25°C

| Parameter | Symbol | Rating | Unit |
|---|----------------|-------------------|------|
| Drain-Source Voltage | V_{DS} | 1700 | V |
| Gate-Source Voltage | V_{GS} | -10/+25 | V |
| Continuous Drain Current | I_D | $T_C=25^\circ C$ | 72 |
| | | $T_C=100^\circ C$ | 50 |
| Pulsed drain current ($T_C = 25^\circ C$, t_p limited by T_{jmax}) | $I_{D\ pulse}$ | 160 | A |
| Power dissipation ($T_C = 25^\circ C$) | P_{tot} | 338 | W |
| Operating Junction Temperature | T_J | -55 to +150 | °C |
| Storage Temperature | T_{STG} | -55 to +150 | °C |

Thermal Resistance

| Parameter | Symbol | Rating | Unit |
|---|------------|--------|------|
| Thermal Resistance, Junction-to-Case | R_{thJC} | 0.37 | °C/W |
| Thermal Resistance, Junction-to-Ambient | R_{thJA} | 40 | °C/W |

Electrical characteristics per line@25°C (unless otherwise specified)

| Parameter | Symbol | Conditions | Min. | Typ. | Max. | Units |
|---|--------------|---|------|------|------|------------|
| Statistic Characteristics | | | | | | |
| Drain-Source Breakdown Voltage | BV_{DSS} | $V_{GS} = 0V, I_D = 100\mu A$ | 1700 | - | - | V |
| Zero Gate Voltage Drain Current @ $V_{DS} = 1700V, V_{GS} = 0V$ | I_{DSS} | $T_C = 25^\circ C$ | - | 1 | 100 | μA |
| | | $T_C = 175^\circ C$ | - | 10 | - | |
| Gate-Body Leakage Current | I_{GSS} | $V_{GS} = 20V, V_{DS} = 0V$ | - | 10 | 600 | nA |
| Gate Threshold Voltage | $V_{GS(th)}$ | $V_{DS} = V_{GS}, I_D = 18mA$ | 2.0 | 2.6 | 4.0 | V |
| Drain-Source On-State Resistance @ $V_{GS} = 20V, I_D = 50A$ | $R_{DS(ON)}$ | $T_J = 25^\circ C$ | - | 27 | 45 | m Ω |
| | | $T_J = 150^\circ C$ | - | 45 | - | |
| Dynamic Characteristics | | | | | | |
| Input Capacitance | C_{iss} | $V_{DS} = 1000V, f = 1MHz, V_{GS} = 0V$ | - | 5070 | - | pF |
| Output Capacitance | C_{oss} | | - | 240 | - | |
| Reverse Transfer Capacitance | C_{rss} | | - | 50 | - | |
| Transconductance | g_{fs} | $V_{DS} = 20V, I_D = 20A$ | - | 26.8 | - | S |
| Turn-On Energy (Body Diode) | E_{on} | $V_{GS} = -1.5/20V, I_D = 50A, V_{DS} = 1200V, R_g = 15\Omega$ | - | 5.33 | - | mJ |
| Turn-Off Energy (Body Diode) | E_{off} | | - | 4.07 | - | |
| Turn-on Delay Time | $t_{d(on)}$ | $V_{GS} = -1.5/20V, I_D = 50A, V_{DS} = 1200V, R_g = 15\Omega, L = 250\mu H$ Timing relative to V_{DS} | - | 18 | - | ns |
| Turn-on Rise Time | t_r | | - | 64 | - | |
| Turn-Off Delay Time | $t_{d(off)}$ | | - | 210 | - | |
| Turn-Off Fall Time | t_f | | - | 84 | - | |
| Total Gate Charge | Q_g | $V_{GS} = -5/+20V, V_{DS} = 1200V, I_D = 50A$ | - | 185 | - | nC |
| Gate-Source Charge | Q_{gs} | | - | 45 | - | |
| Gate-Drain Charge | Q_{gd} | | - | 55 | - | |
| Gate Resistance | R_G | $V_{GS} = 0V, V_{DS} = 0V, f = 1MHz$ | - | 3.5 | - | Ω |
| Reverse Diode Characteristics | | | | | | |
| Body Diode Forward Voltage | V_{SD} | $V_{GS} = -5V, I_{SD} = 25A, T_J = 25^\circ C$ | - | 5.4 | - | V |
| | | $V_{GS} = -5V, I_{SD} = 25A, T_J = 150^\circ C$ | - | 4.8 | - | |
| Body Diode Reverse Recovery Time | t_{rr} | $V_{DS} = 1200V, V_{GS} = -5V, I_{SD} = 50A, di/dt = 1053A/\mu s$ | - | 96 | - | ns |
| Body Diode Reverse Recovery Charge | Q_{rr} | | - | 915 | - | nC |

Typical Characteristics

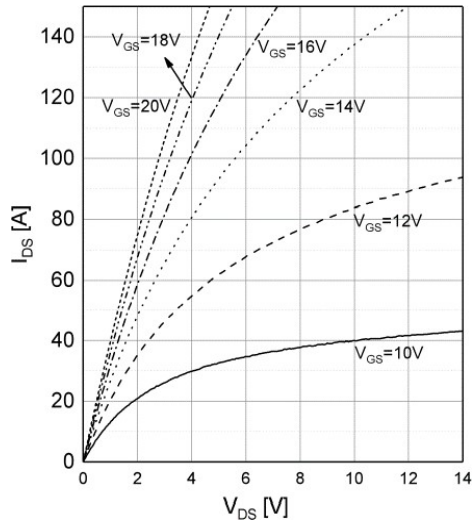
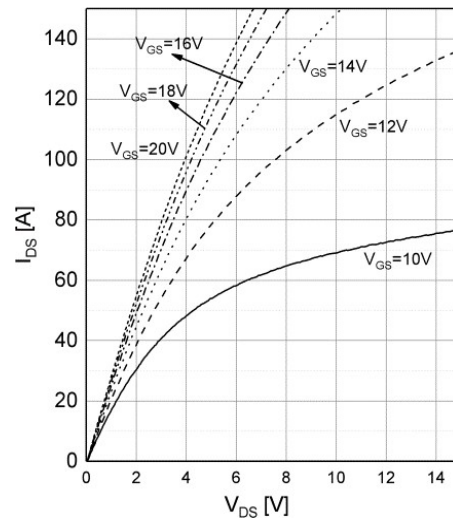
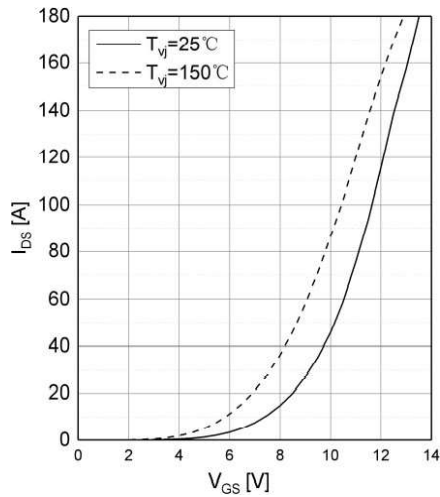
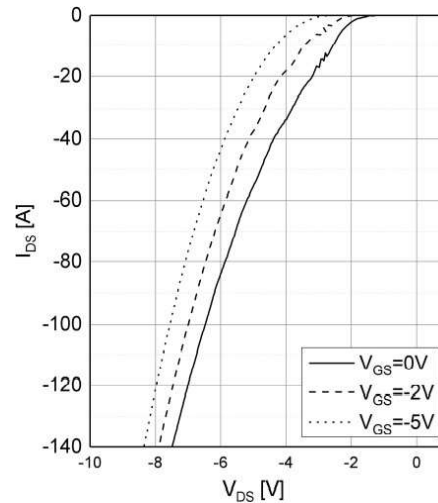
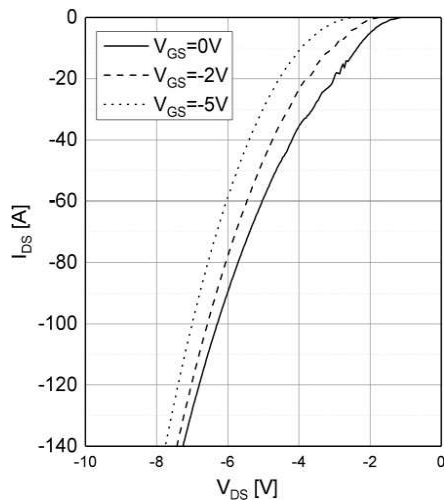
Fig 1. Output Characteristic ($T_J=25^\circ\text{C}$)Fig 2. Output Characteristic ($T_J=150^\circ\text{C}$)Fig 3: Transfer Characteristic ($V_{DS}=20\text{V}$)Fig 6: Body-diode Characteristic ($T_J=25^\circ\text{C}$)Fig 7: Body-diode Characteristic ($T_J=150^\circ\text{C}$)

Product dimension (TO-247-3L)

Unit:mm

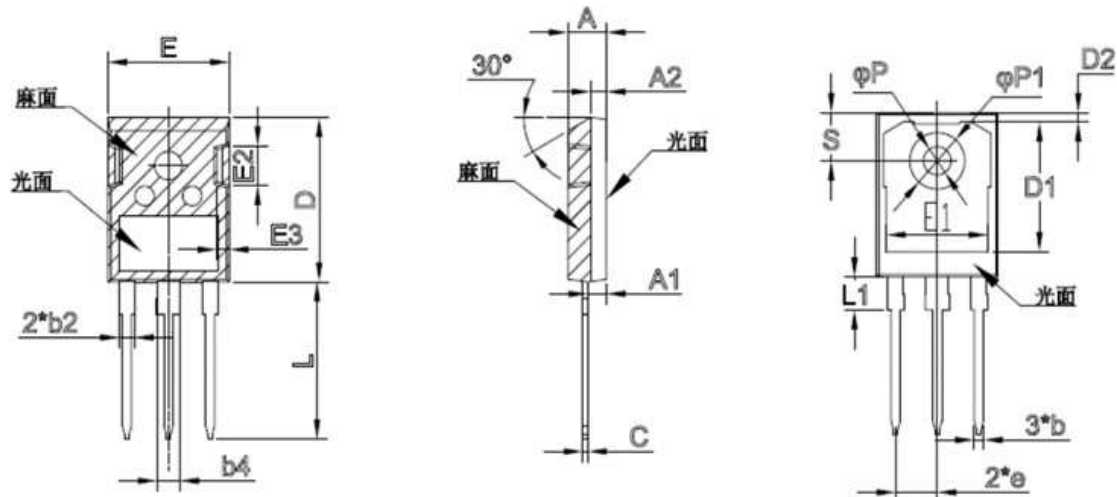

| TO247-3L | | | | | | | |
|----------|-------|-------|-------|----|-------|-------|-------|
| | Min | Nom | Max | | Min | Nom | Max |
| A | 4.70 | 5.00 | 5.20 | E1 | 13.06 | 13.26 | 13.56 |
| A1 | 2.30 | | 2.50 | E2 | 4.90 | 5.00 | 5.10 |
| A2 | 1.90 | 2.00 | 2.10 | E3 | 1.50 | 1.60 | 1.70 |
| b | 1.10 | 1.20 | 1.30 | e | 5.34 | 5.44 | 5.54 |
| b2 | | 2.00 | | L | 19.80 | 20.00 | 20.32 |
| b4 | | 3.00 | | L1 | | 4.17 | 4.50 |
| C | 0.5 | 0.6 | 0.7 | P | 3.50 | 3.60 | 3.70 |
| D | 20.8 | 20.95 | 21.1 | P1 | 7.00 | 7.19 | 7.40 |
| D1 | | 16.55 | | S | 6.04 | 6.15 | 6.3 |
| D2 | 0.95 | 1.17 | 1.35 | | | | |
| E | 15.48 | 15.88 | 16.28 | | | | |
| | | | | | | | |

IMPORTANT NOTICE

 and **Prisemi**[®] are registered trademarks of **Prisemi Electronics Co., Ltd** (Prisemi), Prisemi reserves the right to make changes without further notice to any products herein. Prisemi makes no warranty, representation or guarantee regarding the suitability of its products for any particular purpose, nor does Prisemi assume any liability arising out of the application or use of any product or circuit, and specifically disclaims any and all liability, including without limitation special, consequential or incidental damages. “Typical” parameters which may be provided in Prisemi data sheets and/or specifications can and do vary in different applications and actual performance may vary over time. All operating parameters, including “Typicals” must be validated for each customer application by customer’s technical experts. Prisemi does not convey any license under its patent rights nor the rights of others. The products listed in this document are designed to be used with ordinary electronic equipment or devices, Should you intend to use these products with equipment or devices which require an extremely high level of reliability and the malfunction of with would directly endanger human life (such as medical instruments, aerospace machinery, nuclear-reactor controllers, fuel controllers and other safety devices), please be sure to consult with our sales representative in advance.

Website: <http://www.prisemi.com>

For additional information, please contact your local Sales Representative.

©Copyright 2009, Prisemi Electronics

 **Prisemi**[®] is a registered trademark of Prisemi Electronics.

All rights are reserved.